

LL0010918

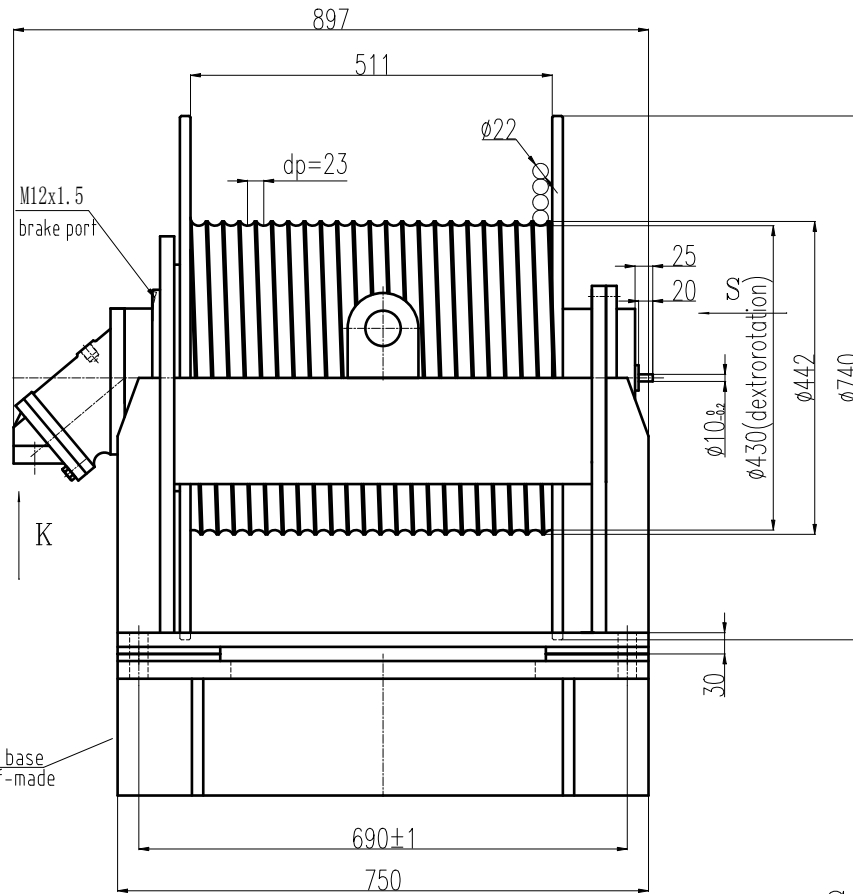

Oil inlet from port B (enhancement) ← → Oil inlet from port A (lowered)

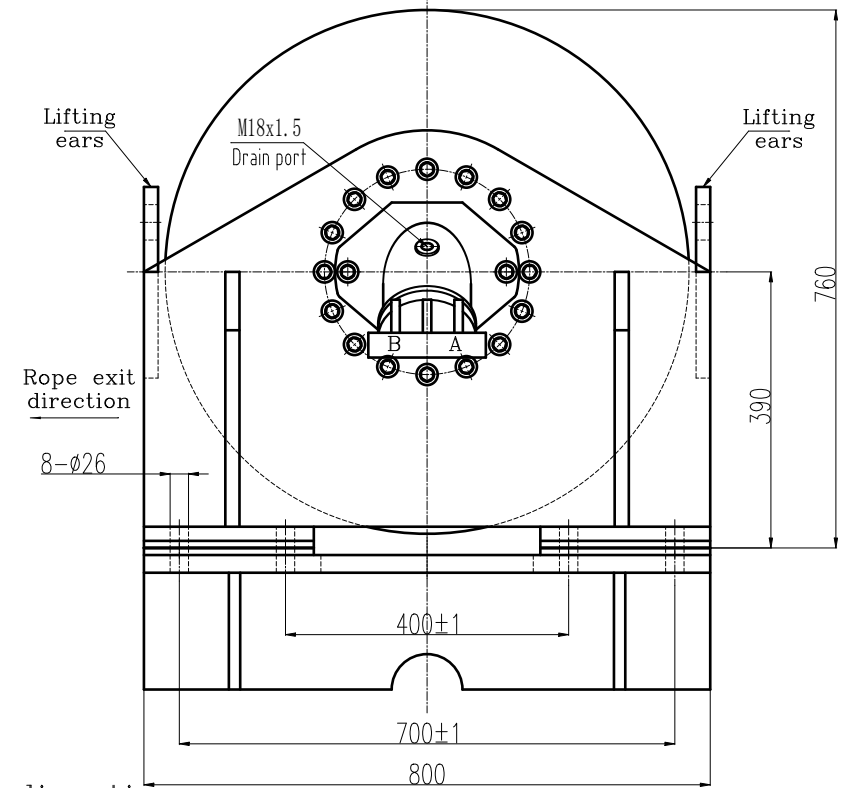

借通用件登记

Technical parameters of winch

描图	First layer rated tension (KN)	80
	Rated rope speed of the first layer(m/min)	0-25
校核	Total displacement (ml/r)	9744
	Working pressure difference (MPa)	14.0
	Steel rope diameter (mm)	22
旧版图总号	Number of rope wrapping layers (layers)	4
	Rope capacity of drum (m)	140
	Pump theoretical oil supply flow (L/min)	187 ( $\eta v=0.92$ )
签字	Hydraulic motor model	A2FE80WVZL
	Reducer model	FFT24W3(i=121.8)
日期	Reducer static braking torque (N.m)	715
	Brake opening pressure (MPa)	1.8-2.5
	Lubricating oil grade	220 (40°) LS2 industrial gear oil

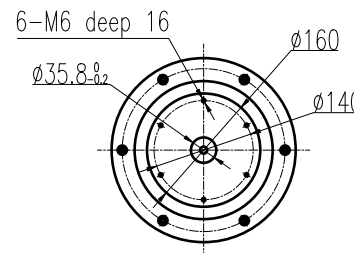
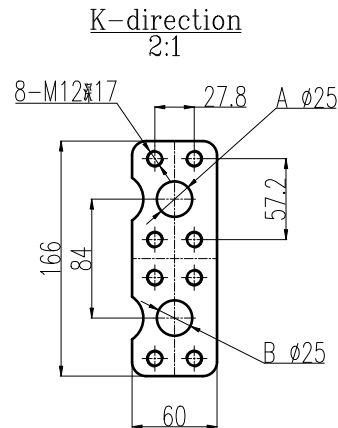

				FJ24-80-140-22-ZP-A2FE80			Ningbo Flag-up Hydraulic	
mark number	changed file number	signature	date	pattern mark	weight	proportion	80KN hydraulic bridge lifting winch	
designer		approver				1:4	816010077	
inspector								
craft								
standard		date		version		visual angle		