

# Axis Electric Joystick with Proportional Push

## Rocker Switch

Model: 81150038



### Advantage

1. Built-in non-contact Hall device to detect angle change and long life.
2. The spring automatically resets.
3. Different output voltage ranges can be selected according to needs.
4. It can be equipped with the upper end of a variety of handles.



# APPLICATION

- aerial work vehicles
- aerial platform equipment
- other engineering vehicles

## Technical Specifications

Electrical characteristics	
Sensor type:	Hall effect
Resolution:	Unlimited
Supply voltage:	$5 \pm 0.5$ VDC
Output:	0.5 to 4.5 VDC
Current consumption:	25 mA
Analog lever supply voltage:	$5.0 \pm 0.5$ VDC
Analog lever output voltage:	1.15 to 2.5 to 3.85 V
Mechanical characteristics	
Mechanical travel angle:	$\pm 18^\circ$ on shaft
Service life:	>10 million cycles
Vibration:	7.67 Gs RMS
Shock:	50 Gs
Environment parameters	
Operating Temperature:	-30°C to 80°C
Storage Temperature:	-40°C to 85°C
EMI/RFI Level:	100 V/m
Protection:	Cylindrical Handle Above Panel, IP67Below Panel, IP67 with Breather Vent

# Electrical characteristics

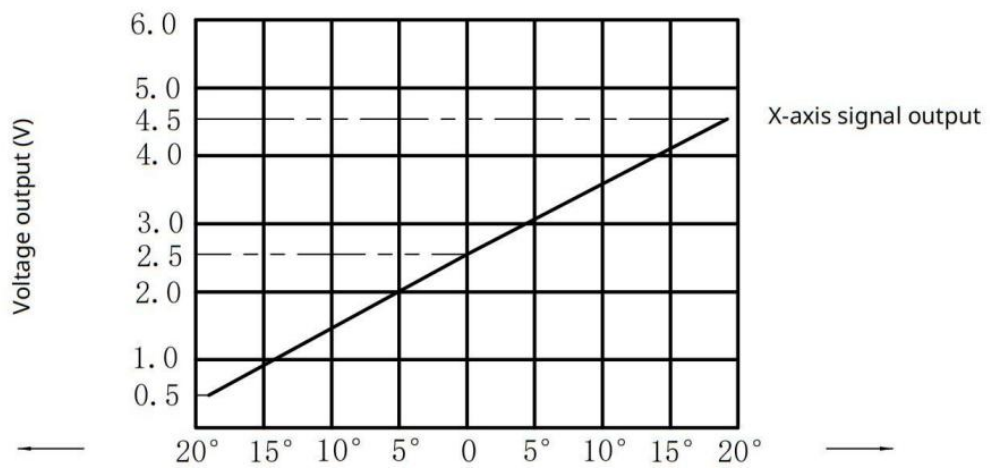
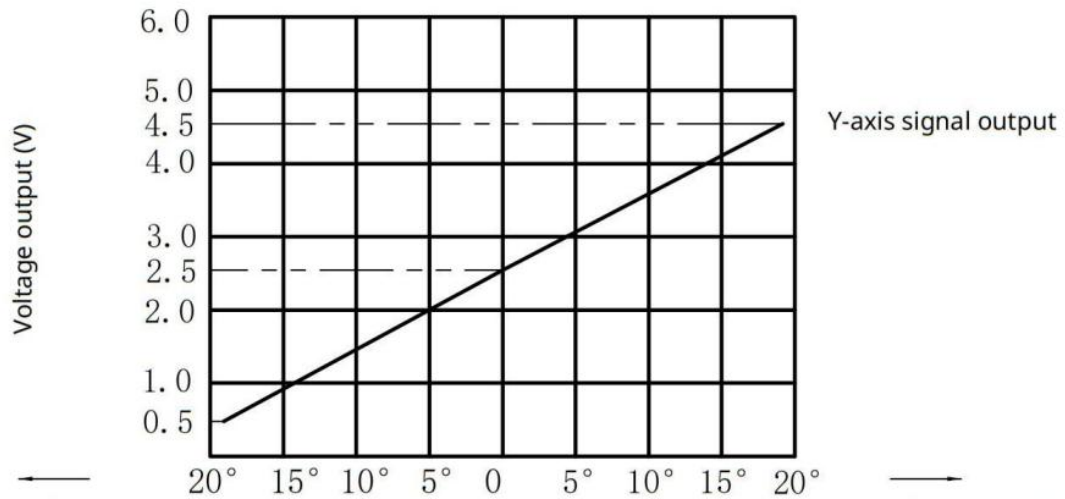

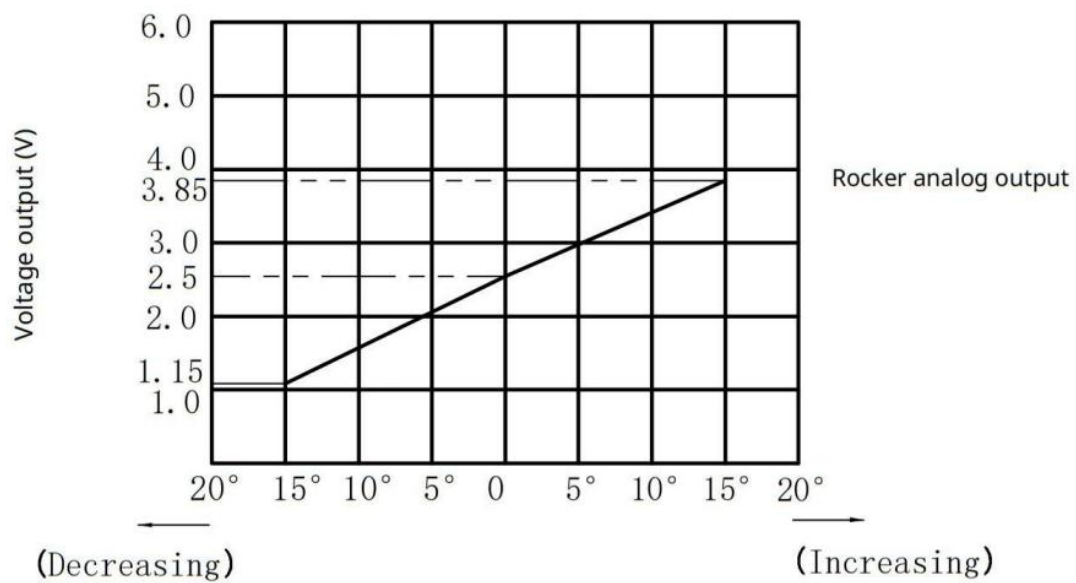

Pin Assignment	
Pin 1	GND
Pin 2	5V
Pin 3	X Signal Output
Pin 4	Y Signal Output
Pin 5	Rocker Analog Output
Pin 6	No connection

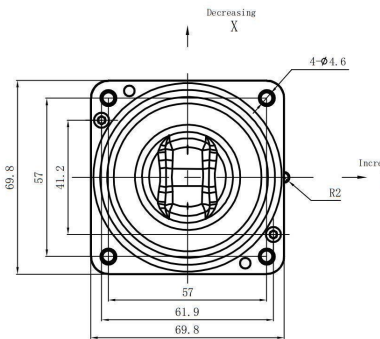
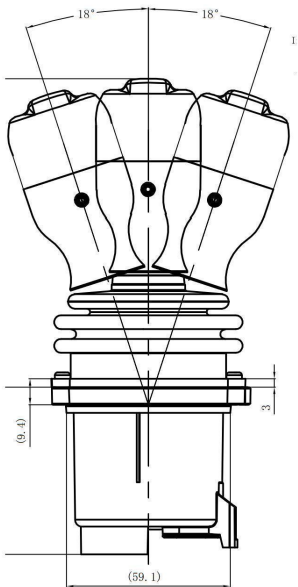
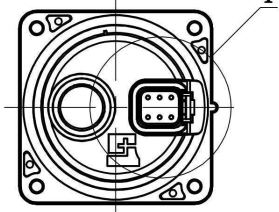

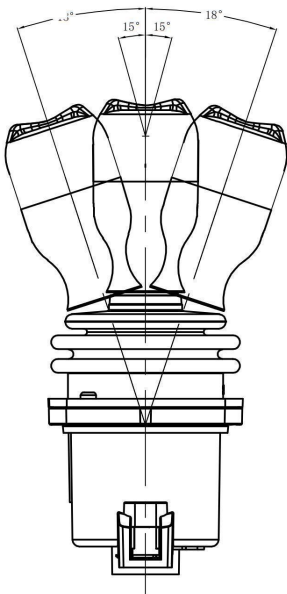

I

1:1

