

High-altitude Work Machine Electric Joystick with Proportional Push Rocker Switch



Advantage

1. Built-in non-contact Hall device to detect angle change and long life.
2. The spring automatically resets.
3. Different output voltage ranges can be selected according to needs.
4. It can be equipped with the upper end of a variety of handles.



APPLICAGION

- aerial work vehicles
- aerial platform equipment
- other engineering vehicles

Technical Specifications

Power Supply Rules:	
Supply voltage:	5 ± 0.5 VDC
Permissible Overvoltage Limit:	20VCD
Output:	0.5 to 4.5 VDC
Permissible Reverse Overvoltage Limit:	-10VDC
Current consumption:	11mA (Single Axis)
Output Voltage Linearity Error:	$< \pm 0.2$ V
Mechanical characteristics	
Mechanical center position:	$\pm 2^\circ$
Operation Temperature:	-30°C to 70°C
EMI/RFI Level:	100 V/m
Operation method:	Automatic spring return
Swing angle:	$\pm 20^\circ$

Electrical characteristics

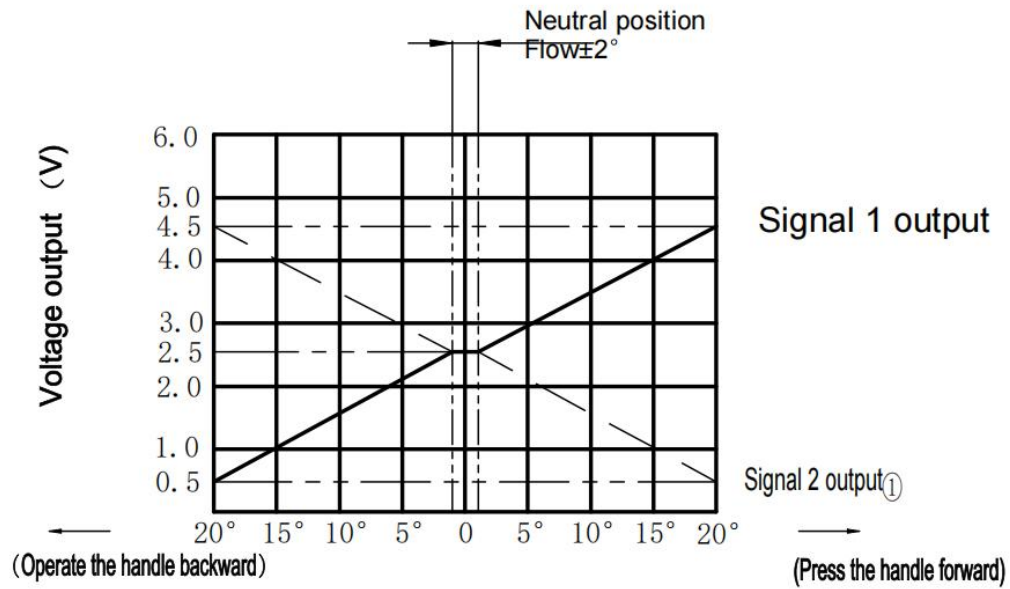

2.signal output

Temperature	0.5V	Median	4.5V
-30~70℃	±0.2V	±0.2V	±0.2V

Shape connetion size

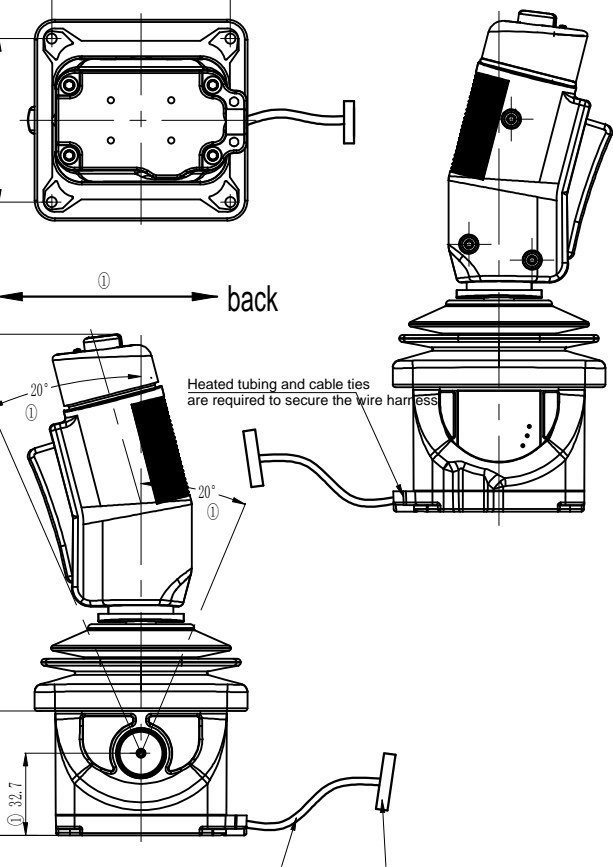

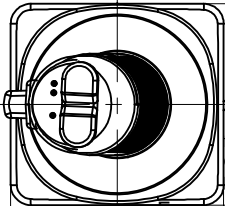

for more
details,
please talk to
us